

Gas Discharge Tube – PG36E-M Series

Features

- DC Spark-over voltage: 75~600V
- Low Capacitance
- Micro-Gap Design
- Stable breakdown voltage
- RoHS & HF compliant
- High holdover voltage
- High insulation resistance
- Large absorbing transient current capability.

Applications

- Communication equipment
- Test equipment
- Data lines
- CATV equipment
- Power Supplies
- Telecom SLIC protection
- Telecommunications

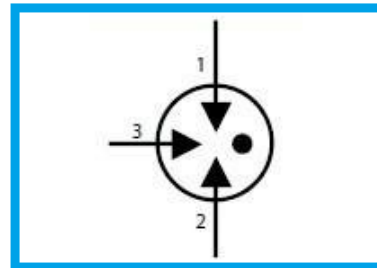

General Characteristics Definition

- Operating temperature: -40 ~ 85°C
- Storage temperature: -40 ~ 85°C

Part Number Code

P G □ □ □ □ □ □ □ □ □ □

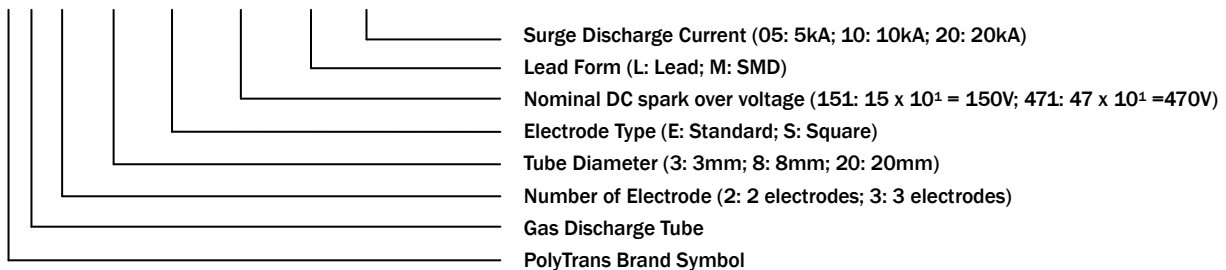

Physical Dimensions

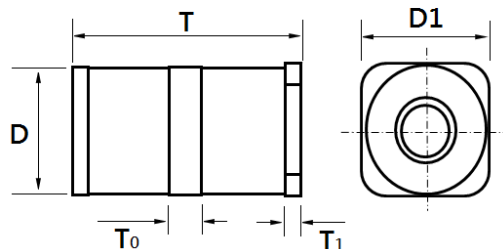

Symbol	Dimension (mm)
D	6.0±0.5
D ₁	6.0±0.5
T	8.2±0.5
T ₀	1.60±0.1
T ₁	1.0±0.1

Solder pad layout

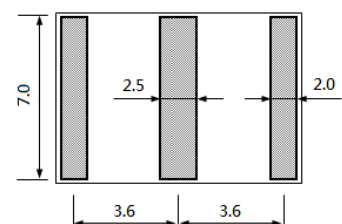

Gas Discharge Tube – PG36E-M Series

Electrical Characteristics

Part Number	DC Spark-over Voltage @ 100V/S	Impulse Spark-over Voltage @ 1kV/ μ S	Impulse Discharge Current	AC Discharge Current	Minimum Insulation Resistance	Maximum Capacitance @ 1.0 MHz	UL Certificate (E474915)
	(V)	(V)	8/20 μ s 10 Hits (kA)	1s/5 Times (A)			
PG36E075M10	75 \pm 20%	\leq 600	10	10	1	1.0	✓
PG36E091M10	90 \pm 20%	\leq 600	10	10	1	1.0	✓
PG36E151M10	150 \pm 20%	\leq 600	10	10	1	1.0	✓
PG36E201M10	200 \pm 20%	\leq 700	10	10	1	1.0	✓
PG36E231M10	230 \pm 20%	\leq 700	10	10	1	1.0	✓
PG36E301M10	300 \pm 20%	\leq 900	10	10	1	1.0	✓
PG36E351M10	350 \pm 20%	\leq 1000	10	10	1	1.0	✓
PG36E401M10	400 \pm 20%	\leq 1000	10	10	1	1.0	✓
PG36E471M10	470 \pm 20%	\leq 1200	10	10	1	1.0	✓
PG36E601M10	600 \pm 20%	\leq 1400	10	10	1	1.0	✓

Marking Definitions

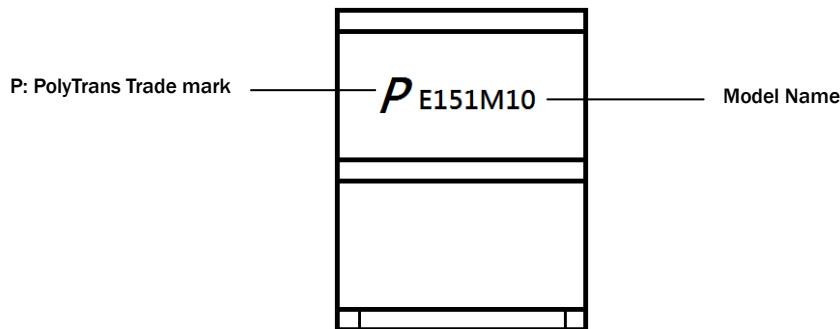

Lead Free Reflow Soldering Recommendations

Preheat	
- Temperature Min (T _{smin})	150°C
- Temperature Max (T _{smax})	200°C
- Time (T _{smin} to T _{smax})	60-180 seconds
- Average Ramp-Up Rate	1~3°C/second
Peak Temperature	260°C max.
Time within 5°C of actual Peak Temperature (t_p)	40 seconds max.
Ramp-Down Rate	6 °C /second max.

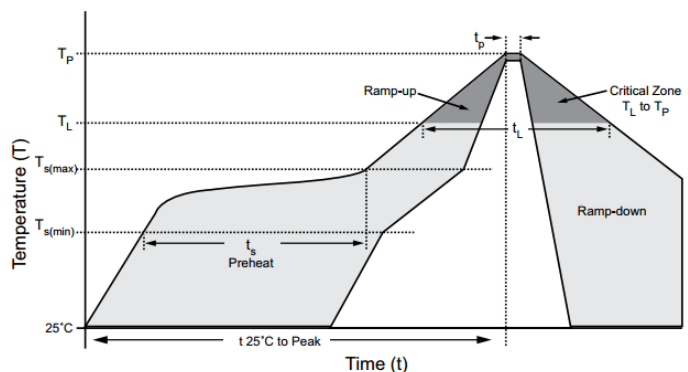

Note: If the reflow soldering temperatures exceed the recommended profile, devices may not meet the performance requirements.

Gas Discharge Tube – PG36E-M Series

Packaging Information

Part Number	Quantity (EA/Roll)
PG36E-M Series	750

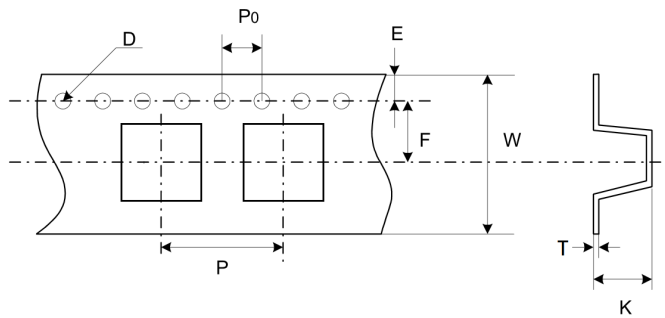

Dimension	Millimeters
P	12.0±0.1
P0	4.0±0.1
D	1.55±0.05
E	1.75±0.1
F	11.5±0.1
W	24.0±0.3
T	0.50±0.05
K	6.30±0.10